

LANDSCAPED BUFFER INCLUDING 6" HIGH PLANTED BERM, AND NO TREES TALLER THAN 15' WITHIN 20' OF THE PROPERTY LINE AS REQUESTED BY NEIGHBORS. NEIGHBORS HAVE ALSO REQUESTED FLOWERING TREES AND TREES WITH FALL FOLIAGE.

NOTES:
 TREE SAVE FENCE FOR ENTIRE SITE MUST BE INSTALLED, INSPECTED AND APPROVED PRIOR TO INSTALLATION OF EROSION CONTROL MEASURES. NO LAND DISTURBANCE OR DEMOLITION IS ALLOWED BEFORE TREE SAVE FENCING HAS BEEN INSPECTED AND APPROVED BY COMMUNITY DEVELOPMENT DIRECTOR.

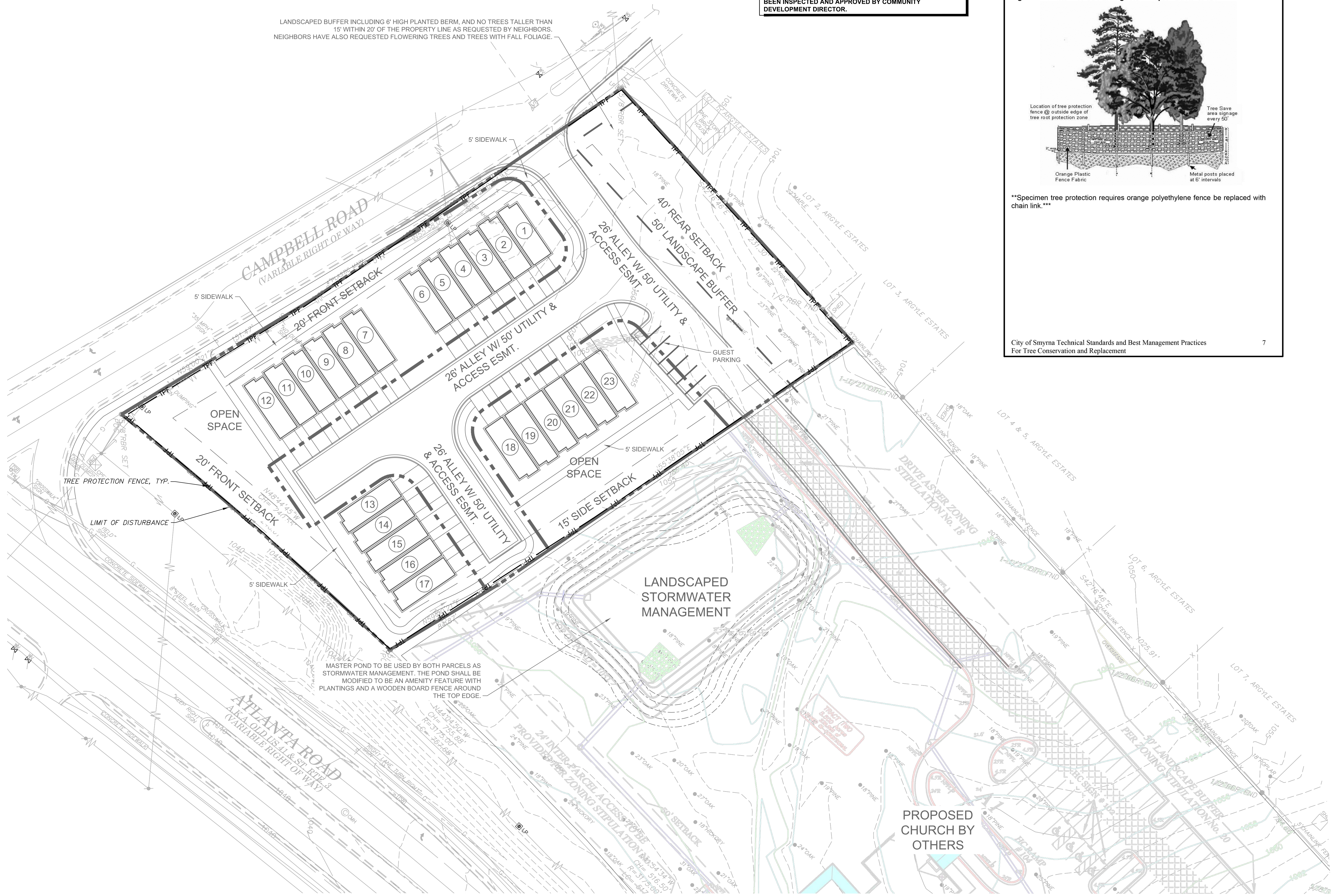
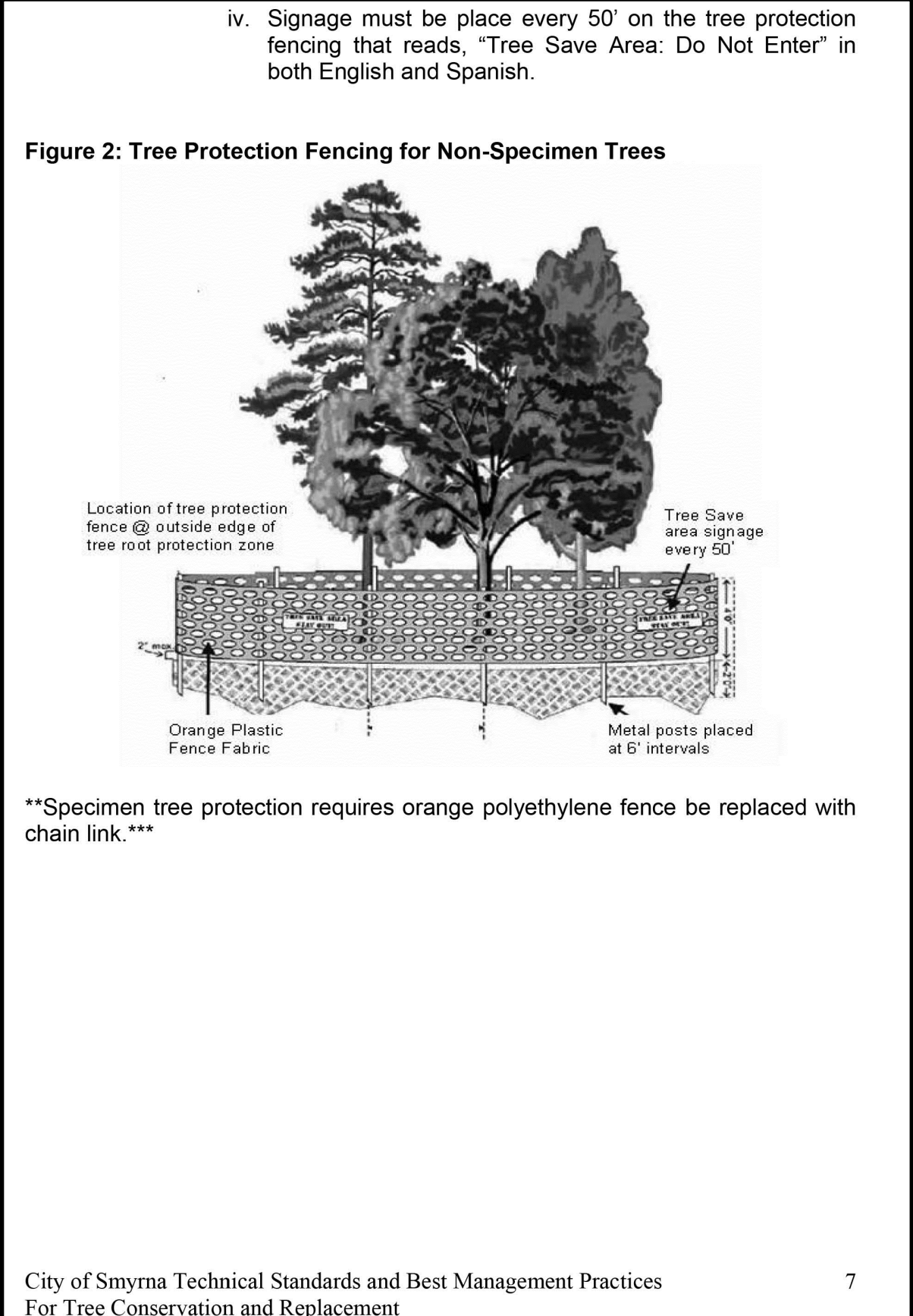

CAMPBELL RD SE @ ATLANTA RD SE
 A MASTER PLANNED RESIDENTIAL DEVELOPMENT
 FOR
 GEORGE S. MORGAN DEVELOPMENT COMPANY, INC.
 2802 PAGES FERRY RD
 SUITE 100
 ATLANTA, GA 30039
 PHONE: 404-786-0489

CITY OF SMYRNA
 COBB COUNTY
 GEORGIA

"WE PROVIDE SOLUTIONS"
PLANNERS AND ENGINEERS COLLABORATIVE
 SITE PLANNING @ LANDSCAPE ARCHITECTURE @ CIVIL ENGINEERING @ LAND SURVEYING
 @ 350 RESEARCH COURT @ PEACHTREE CORNERS, GEORGIA 30092 @ (770) 451-2741 @ FAX (770) 451-3915 @

LAND LOT 700
 1.58 ACRES

REVISIONS:

NO.	DATE	BY	DESCRIPTION

This drawing is the property of Planners and Engineers Collaborative and is not to be copied in whole or in part. It is not to be used on any other project and is to be returned upon request. © Planners and Engineers Collaborative

TREE PROTECTION PLAN

SCALE: 1" = 30'
 DATE: February 25, 2021
 PROJECT: 12082.01

THIS SEAL IS ONLY VALID IF COUNTER SIGNED AND DATED WITH AN ORIGINAL SIGNATURE.

PRELIMINARY
 NOT TO BE RELEASED FOR CONSTRUCTION

GEORGIA WEST ZONE

T1
 SHEET