

SCALE: 1" = 500'
 DATE SURVEYED: 11/08/2019
 DATE UPDATED: N/A
 SURVEYED BY: RKG
 DATE DRAFTED: 11/11/2019
 UPDATE DRAFTED: N/A
 DRAWN BY: RKG
 CHECKED BY: BCP
 FIELD BOOK #: N/A
 JOB NUMBER: 191105
 FOLDER NUMBER: 191105
 COGO FILE: N/A
 DISC FILE: 191105-ALC-SMYRNA
 COUNTY/LL/D/S: COBB/634/17
 PLAT FILE: A
 SHEET: 1 OF 1



WATTS & BROWNING ENGINEERS, INC.

CIVIL ENGINEERS & LAND SURVEYORS
 1349 OLD 41 HWY NW, SUITE 225
 MARIETTA, GEORGIA 30060

PHONE: (678) 324-6192
 FAX: (770) 694-6870

WWW.WBENG.COM
 LSF000429 - PEF000714

GRAPHIC SCALE

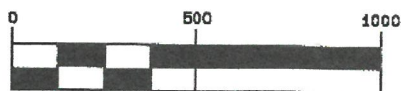

(IN FEET)

1 inch = 500 ft.

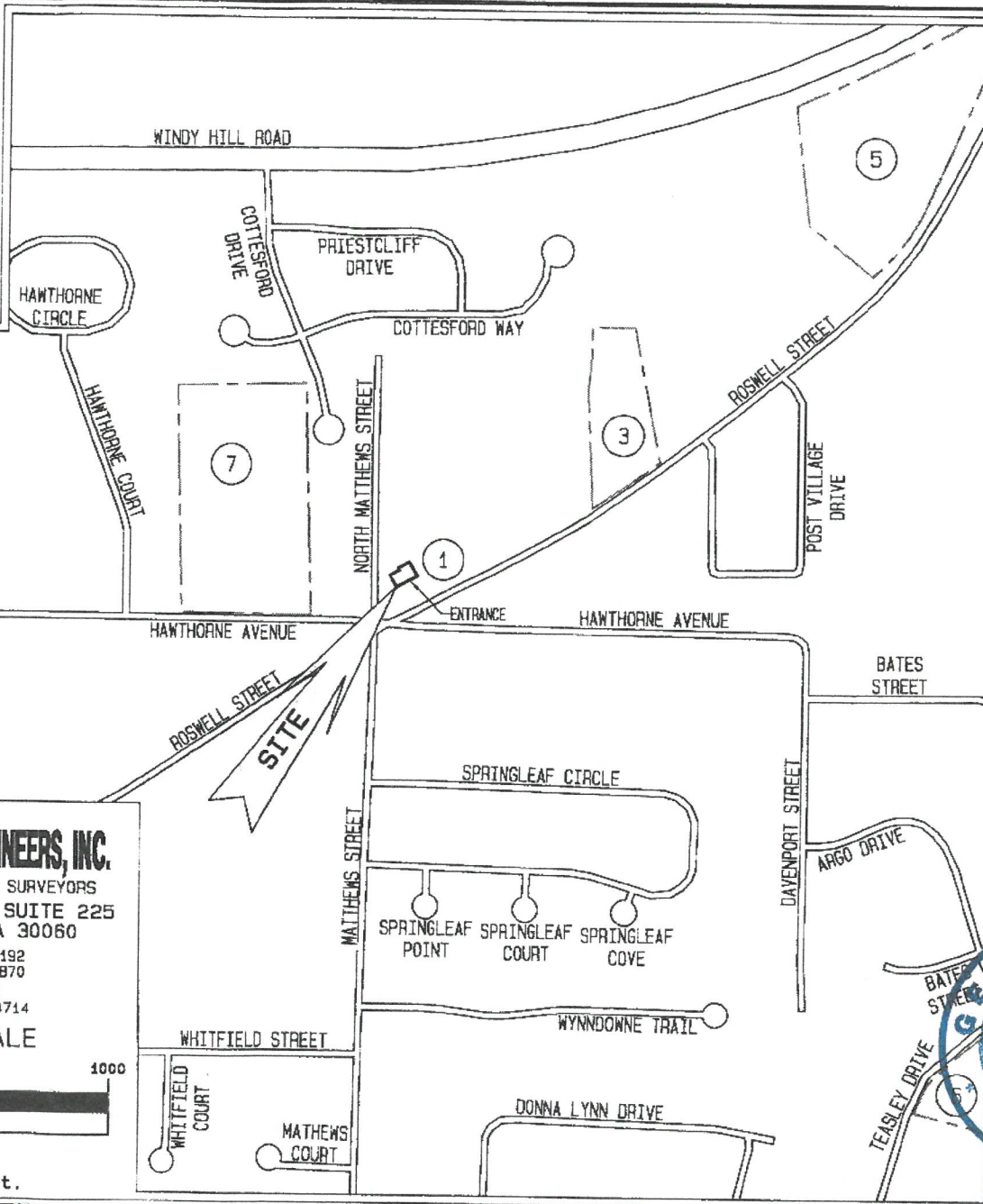

- SITE: 5 POINT FOOD STORE**
1649 ROSWELL STREET, S.E., SMYRNA, GA 30080
- SCHOOL: SMYRNA ELEMENTARY SCHOOL**
1099 FLEMING STREET (NOT SHOWN)
4,750 FEET± ROUTE OF TRAVEL, ENTRANCE-PROPERTY LINE
4,665 FEET± STRAIGHT LINE, ENTRANCE-PROPERTY LINE (STATE 560.2.2.12)
- CHURCH: CELESTIAL CHURCH OF CHRIST NORTH ATLANTA PARISH SMYRNA**
1755 ROSWELL STREET
620 FEET± ROUTE OF TRAVEL, ENTRANCE-PROPERTY LINE
- ALC-TREAT-CTR: COBB/ DOUGLAS COMMUNITY SERVICE BOARD**
1650 COUNTY SERVICES PARKWAY, MARIETTA (NOT SHOWN)
4.7 MILES± STRAIGHT LINE, ENTRANCE-ENTRANCE (STATE 560.2.2.12)
- LIBRARY: WINDY HILL LIBRARY**
1885 ROSWELL STREET
1,675 FEET± ROUTE OF TRAVEL, ENTRANCE- PROPERTY LINE
- PARK: ROSE GARDEN PARK**
1839 TURPIN ROAD
2,735 FEET± ROUTE OF TRAVEL, ENTRANCE- PROPERTY LINE
- PUBLIC BUILDING: 1595 HAWTHORNE AVENUE**
335 FEET± ROUTE OF TRAVEL, ENTRANCE- PROPERTY LINE

NOTE: FOR THIS SURVEY THE DISTANCES SHOWN HEREON (UNLESS OTHERWISE INDICATED) WERE MEASURED IN ACCORDANCE WITH THE CITY OF SMYRNA ORDINANCE (SECTION 6-118(c)(1)) FROM THE CENTER OF THE NEAREST DOOR OF CUSTOMER ENTRY OF THE PROPOSED LICENSE PREMISES BY THE MOST DIRECT ROUTE OF TRAVEL IN A STRAIGHT LINE ON THE GROUND BY A PEDESTRIAN FROM THE CUSTOMER DOOR TO THE PROPERTY LINE OF THE CHURCH, SCHOOL, PARK, PUBLIC BUILDING, LIBRARY, OR RESIDENCE AND SUCH TRAVEL WAS MEASURED AS A STRAIGHT LINE FROM THE CUSTOMER DOOR TO THE PROPERTY LINE AND RUNNING ALONG THE NEAREST SIDEWALK OR STREET ROUTE; PROVIDED THAT, WHEN A STRAIGHT LINE OF TRAVEL WOULD NOT BE A CUSTOMARY AND REASONABLE LINE OF TRAVEL BECAUSE OF OBSTACLES TO SUCH TRAVEL, THE LINE OF TRAVEL WAS ANGLED AROUND SUCH OBSTACLES AND THE DISTANCE WAS THE SUM OF THE SEGMENTS OF THE LINE.

PLAT TO ACCOMPANY
 ALCOHOLIC BEVERAGE LICENSE FOR
NADIA LLC.

D/B/A

5 POINT FOOD STORE

1649 ROSWELL STREET, S.E.
 SMYRNA, GEORGIA 30080

LAND LOT 634

17TH DISTRICT

CITY OF SMYRNA

COBB COUNTY, GEORGIA

NOVEMBER 11, 2019

REVISED DECEMBER 16, 2019

SCALE 1" = 500'

