

## ALCOHOLIC BEVERAGE LICENSE SURVEY

To:

Date: 04/23/2020

Applicant's Name: \_\_\_\_\_

Trade Name: \_\_\_\_\_

Business Address: 2900 S COBB DRIVE SUITE 1-A SMYRNA, GA 30082

### **BEER AND / WINE (100 YARDS MINIMUM)**

1. 500 Number of yards to the nearest church or place used primarily for religious services at:  
Church Adventista Marietta Central - 531 Plaza Dr SE
2. 202 Number of yards to the nearest school, school grounds, educational facility or college campus; this includes kindergartens, or churches, which have schools or kindergartens, located at:  
Compass Academy Preschool & Childcare - 2820 Cobb Ln

3. 9152 Number of yards (must be at least 200 yards for **Beer, Wine or Distilled Spirits**) to the nearest alcohol treatment center located at:  
Safety Net Recovery - 3656 Highlands Pkwy SE

### **LIQUOR (200 YARDS MINIMUM)**

1. 500 Number of yards to the nearest church or place used primarily for religious services at:  
Church Adventista Marietta Central - 531 Plaza Dr SE
2. 9152 Number of yards (must be at least 200 yards) to the nearest alcohol treatment center located at:  
Safety Net Recovery - 3656 Highlands Pkwy SE
3. 202 Number of yards to nearest school, school grounds and college campus; this includes kindergartens or churches, which have schools or kindergartens located at:  
Compass Academy Preschool & Childcare - 2820 Cobb Ln

**NOTE: ALL MEASUREMENTS SHALL BE MEASURED BY THE MOST DIRECT ROUTE OF TRAVEL ON THE GROUND (WALKING or DRIVING) AND SHALL BE MEASURED IN THE FOLLOWING MANNER:**

- (a). From the front door of the structure from which alcoholic beverage is to be sold or served;
- (b) In a straight line to the nearest public sidewalk, street, highway, road or walkway;
- (c) Along such public sidewalk, street, highway, road or walkway;
- (d) To the front door of the building, unless you are measuring to an educational facility (schools and school grounds). When measuring to a school, the measurement stops at the nearest property line of the school.

Note: Survey drawing showing distance to the businesses described above must be attached to this survey certificate.

The undersigned surveyor has examined the subject location and has made measurements to determine compliance or non-compliance with the above distance requirements.

Eugene A. Stepanov  
Signature of Land Surveyor

\*\* Revised 09-20-05

3197  
State License Number

04/23/2020  
Date



# DISTANCE MEASUREMENT

THE DISTANCE WAS MEASURED BY THE MOST DIRECT ROUTE OF TRAVEL ON THE GROUND AND WAS MEASURED IN THE FOLLOWING MANNER:

- FROM THE FRONT DOOR OF STRUCTURE FROM WHICH BEVERAGE ALCOHOL IS SOLD OR OFFERED FOR SALE;
- IN A STRAIGHT LINE TO THE NEAREST PUBLIC SIDEWALK, WALKWAY, STREET, ROAD OR HIGHWAY;
- ALONG SUCH PUBLIC SIDEWALK, WALKWAY, STREET, ROAD, OR HIGHWAY BY NEAREST ROUTE;
- TO FRONT DOOR OF THE BUILDING, OR TO THE NEAREST PORTION OF THE GROUNDS, WHICHEVER IS APPLICABLE UNDER THE CODE.

NOTE: SEE ATTACHED DOCUMENT:  
REPORT OF SURVEY FOR ALCOHOLIC BEVERAGE LICENSE

PEDESTRIAL TRAVEL IS CALCULATED  
BY USING MEASURING WHEEL, LUFKIN PRO SERIES

NOTE A  
FRONT DOOR OF  
2900 S COBB DRIVE  
SUITE 1-A  
SMYRNA, GA 30082

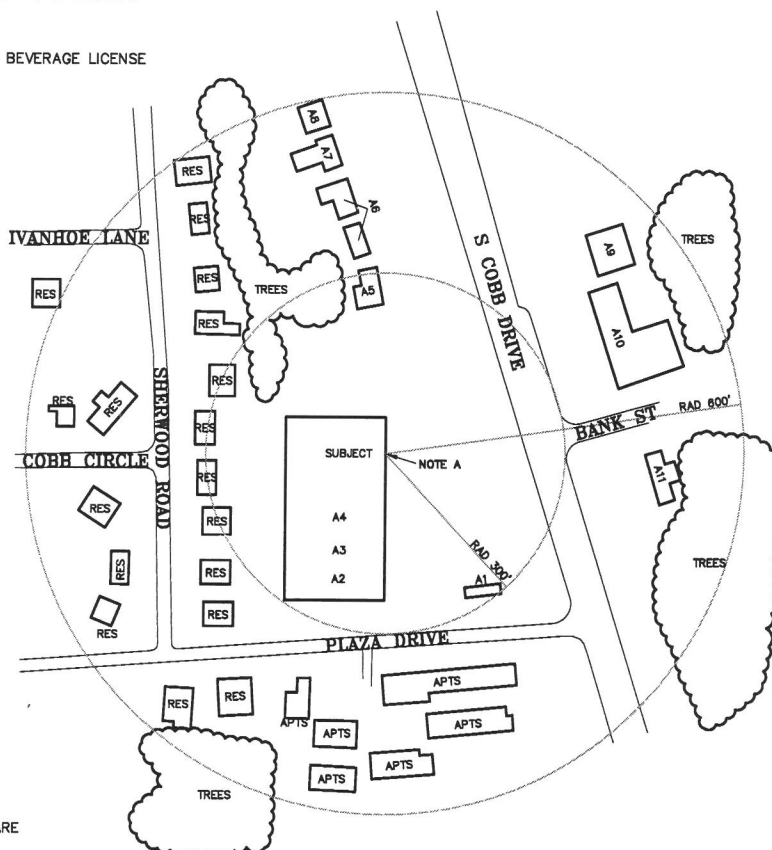

- A1-SMOOTHIE KING  
A2-AARON TRAINING CENTER  
A3-FRANKLIN DENTAL & BRACES  
A4-FORMAL 4U  
A5-THE FINISHING TOUCH CLEANING SERVICES  
A6-COMPASS ACADEMY PRESCHOOL AND CHILDCARE  
A7-KOSTAS CHIROPRACTIC CLINIC  
A8-MERRY MAIDS OF MARIETTA  
A9-YOUPHORIA WELLNESS  
A10-DIAMOND AUTO PAINT SOUTH COBB  
A10-CHEVRON GAS STATION

\* BEER, WINE AND LIQUOR LICENSE PERMIT PLAT \*

DISTANCE FROM CLOSEST PRIVATE RESIDENCE:

DISTANCE FROM CLOSEST PRIVATE RESIDENCE ON SAME STREET:  
DISTANCE FROM CLOSEST COLLEGE CAMPUS OR SCHOOL GROUND:

DISTANCE FROM CLOSEST BRANCH OF ANY PUBLIC LIBRARY:

DISTANCE FROM CLOSEST CHURCH OR PLACE OF WORSHIP:

DISTANCE FROM CLOSEST ALCOHOLIC TREATMENT CENTER:

DISTANCE FROM CLOSEST RETAIL PACKAGE STORE:

IS PREMISES FOR LICENSE LOCATED IN A SHOPPING CENTER?

888 FEET 296 YARDS AWAY (2901 Sherwood Rd SE)

MORE THAN 200 YARDS

606 FEET 202 YARDS AWAY (Compass Academy Preschool & Childcare)  
2820 Cobb Ln

6336 FEET 2112 YARDS AWAY (Smyrna Public Library)

100 Village Green Cir

1500 FEET 500 YARDS AWAY (Church Adventista Marietta Central)

531 Plaza Dr SE

27456 FEET 9152 YARDS AWAY (Safety Net Recovery)

3656 Highlands Pkwy SE

3168 FEET 1232 YARDS AWAY (South Cobb Package)

3181 S Cobb Dr SE

(YES)

PROPERTY ADDRESS:  
2900 S COBB DRIVE  
SUITE 1-A  
SMYRNA, GA 30082

PLAT PREPARED FOR:

**JARED SAMPLES**

LOT BLOCK  
SUBDIVISION UNIT TWO  
LAND LOT 378 17TH DISTRICT SECTION  
FULTON COUNTY, GEORGIA

FIELD WORK DATE APR 20, 2020 PRINTED/SIGNED APR 23, 2020

PLAT BOOK ,PAGE ALL MATTERS PERTAINING  
DEED BOOK 13610 ,PAGE 6183 TO TITLE ARE EXCEPTED

THE FIELD DATA UPON WHICH THIS PLAT IS BASED HAS A CLOSURE OF 1 FOOT IN 30,000+ FEET, AN ANGULAR ERROR OF 05 SECONDS PER ANGLE POINT AND WAS ADJUSTED USING THE LEAST SQUARES METHOD. THIS PLAT HAS BEEN CALCULATED FOR CLOSURE AND FOUND TO BE ACCURATE TO 1 FOOT IN 100,000+ FEET. AN ELECTRONIC TOTAL STATION AND A 100' CHAIN WERE USED TO GATHER THE INFORMATION USED IN THE PREPARATION OF THIS PLAT. NO STATE PLANE COORDINATE MONUMENT FOUND WITHIN 500' OF THIS PROPERTY.



IN MY OPINION, THIS PLAT IS A CORRECT REPRESENTATION  
OF THE LAND PLATTED AND HAS BEEN PREPARED IN CONFORMITY  
WITH THE MINIMUM STANDARDS AND REQUIREMENTS OF LAW.

0 200  
SCALE 1" = 200'

JP  
DWG #20200726

**SURVEY LAND EXPRESS, INC**  
LAND SURVEYING SERVICES

24 LENOX POINTE  
ATLANTA, GA 30342  
FAX 404-801-0941  
TEL 404-252-8747  
INFO@SURVEYLANDEXPRESS.COM