

LANDSCAPE PLAN NOTES

1. CONTACT THE COMMUNITY DEVELOPMENT DEPARTMENT (770-319-5387) TO ARRANGE A PRECONSTRUCTION CONFERENCE PRIOR TO ANY LAND DISTURBANCE. NO PERMIT SHALL BE ISSUED UNTIL PLANS ARE APPROVED AND AN ON-SITE INSPECTION WITH CITY REPRESENTATIVES OCCURS.
2. THE CRZ OF SPECIMEN TREES RECEIVING A 3X CREDIT SHALL BE PROTECTED WITH 6-FOOT CHAIN LINK SAVE FENCING SPACED 6 FEET ON CENTER WITH METAL SUPPORT POSTS AND TREE SAVE SIGNAGE. INSTALLATION OF THE TREE SAVE FENCE WILL INVOLVE NO TRENCHING. 3 INCHES OF ORGANIC MULCH OVER THE CRZ AND AN ABOVE GROUND IRRIGATION SYSTEM.
3. ALL TREE PROTECTION MEASURES SHALL BE INSTALLED PRIOR TO GRADING OR THE REMOVAL OF IMPERVIOUS SURFACES OR STRUCTURES.
4. BUFFERS SHALL BE REPLANTED SUBJECT TO COMMUNITY DEVELOPMENT DEPARTMENTAL APPROVAL.
5. TREE SAVE FENCE FOR THE ENTIRE SITE MUST BE INSTALLED, INSPECTED AND APPROVED PRIOR TO THE INSTALLATION OF EROSION CONTROL MEASURES. NO LAND DISTURBANCE OR DEMOLITION IS ALLOWED BEFORE TREE SAVE FENCING HAS BEEN INSPECTED AND APPROVED BY COMMUNITY DEVELOPMENT DIRECTOR.
6. ALL EXISTING TREES, SPECIMEN, AND NON-SPECIMEN, COUNTED FOR EDF CREDITS MUST BE FULLY PRESERVED DURING INDIVIDUAL LOT PERMITTING.
7. ALL TREES MUST BE PLANTED AT LEAST 10 FEET AWAY FROM ANY UTILITY LINE.
8. NO TREES SHALL BE PLANTED ON ANY AREA OF AN EARTHEN DAM OR EMBANKMENT.
9. NO EXISTING TREES ON THE SITE
10. THE COMMUNITY DEVELOPMENT DIRECTOR MUST INSPECT THE SITE BEFORE INSTALLATION OF EROSION CONTROL MEASURES. LAND DISTURBANCE WITHOUT A SITE INSPECTION AND APPROVAL BY THE COMMUNITY DEVELOPMENT DIRECTOR WILL RESULT IN A "STOP-WORK ORDER" AND FINES.
11. IF TREE SURVEY INACCURACIES ARE FOUND ON-SITE, A STOP-WORK ORDER WILL BE ISSUED UNTIL REVISED PLANS ARE APPROVED AND PROCESSED BASED ON ACCURATE INFORMATION.
12. THE COMMUNITY DEVELOPMENT DIRECTOR MUST INSPECT AND APPROVE THE SITE BEFORE THE ISSUANCE OF A CERTIFICATE OF OCCUPANCY.
13. TREES AGREED UPON TO BE SAVED IS THE RESPONSIBILITY OF THE OWNER.
14. A 3-INCH LAYER OF ORGANIC MULCH WILL BE REQUIRED FOR THE CRZ OF SPECIMEN TREES. MULCH MUST BE APPLIED PRIOR TO THE START OF CONSTRUCTION. KEEP MULCH AT LEAST 5-INCH RADIUS AWAY FROM THE TRUNK.
15. A 3-INCH LAYER OF ORGANIC MULCH WILL BE REQUIRED FOR ALL REPLACEMENT TREES. MULCH MUST BE APPLIED PRIOR TO THE START OF CONSTRUCTION. KEEP MULCH AT LEAST 5-INCH AWAY FROM THE TRUNK.
16. ALL NEWLY PLANTED TREES SHALL HAVE VISIBLE ROOT FLARES AT FINISHED GRADE. NO CIRCLING ROOTS SHALL BE ALLOWED ON PLANTED TREES. THE UPPER 1/4 OF THE WIRE BASKET ALL BURLAP, AND STRAPPING SHALL BE CUT AND REMOVED BEFORE THE BACKFILLING OF THE PLANTING HOLE.
17. TREES LESS THAN THE CALIPER INCH SHOWN WILL NOT BE ACCEPTED. EXAMPLE: 4-INCH CALIPER TREES MUST BE 4-INCHES OR LARGER.
18. PLANT HEIGHT MEASUREMENT IS TAKEN AT THE TOP OF THE MAIN BODY OF THE PLANT AND NOT AT THE TOP OF THE TOPMOST GROWTH.
19. ALL NEWLY PLANTED TREES SHALL BE EQUIVALENT IN QUALITY TO FLORIDA #1 GRADE OR BETTER. ALL TREES OF LESSER QUALITY CAN BE REJECTED BY THE COMMUNITY DEVELOPMENT DIRECTOR.
20. WATERING BAGS OR A DRIP IRRIGATION SYSTEM WILL BE PROVIDED FOR ALL TREES PRIOR TO ISSUANCE OF THE CERTIFICATE OF OCCUPANCY. WATER BAGS WILL BE REFILLED ACCORDING TO SOIL CONDITIONS AND ADJUSTED DURING TIMES OF DROUGHTS FOR A MINIMUM OF 2 YEARS AFTER INSTALLATION.
21. NO TRENCHING ALLOWED IN TREE SAFE AREA, INCLUDING IRRIGATION INSTALLATION.
22. ALL TREE GUYING AND STAKES SHALL BE REMOVED FROM THE TREE(S) ONE YEAR AFTER PLANTING DATE.
23. THE DIRECTOR OF COMMUNITY DEVELOPMENT MUST BE NOTIFIED OF COMPLETION OF ANY TREE CARE ITEM IN THE PLAN. PROOF OF COMPLETION MUST ALSO BE SUBMITTED TO DIRECTOR OF COMMUNITY DEVELOPMENT.

Figure 11: Tree Planting Detail

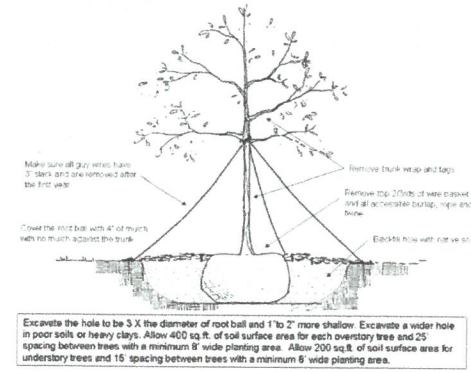

Figure 12: Tunneling or Boring within Tree Root Zones

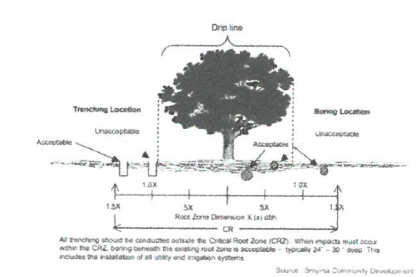
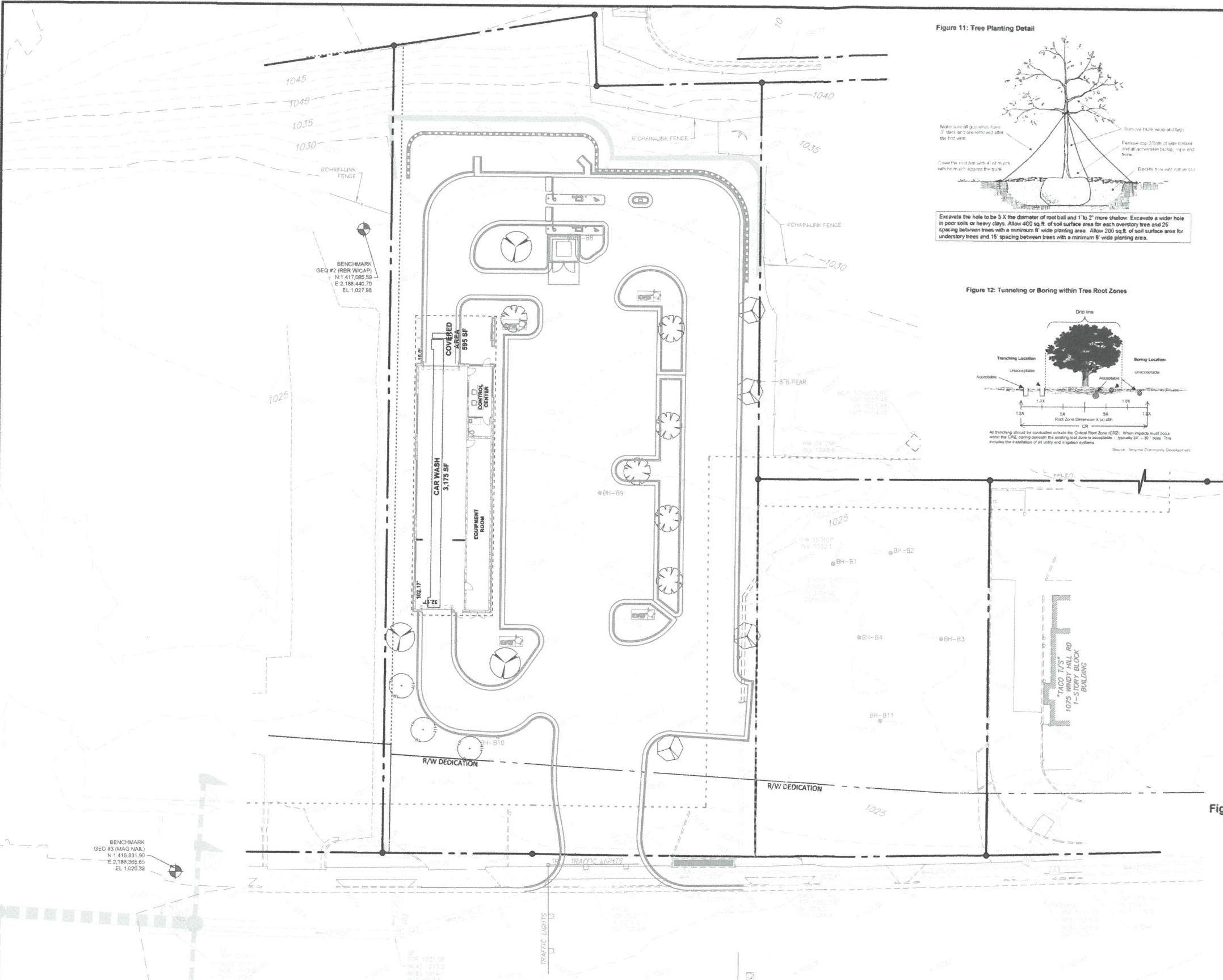
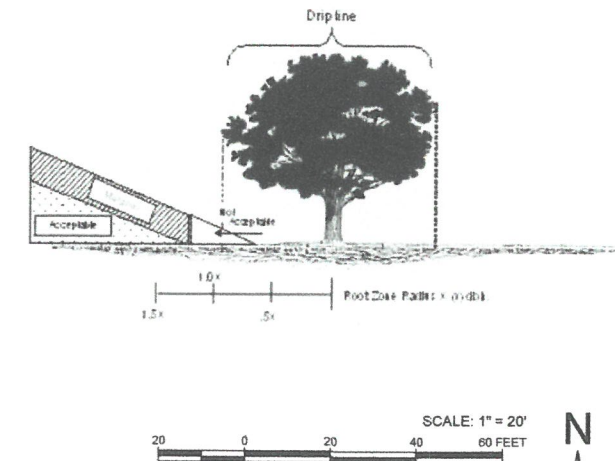

Figure 13: Acceptable Grade Fills Within Root Zones



TREE LEGEND & INVENTORY

SYMBOL	COMMON NAME	LATIN NAME	QTY	CALIPER	SIZE	SPACING	% GENUS
	GINKGO	GINKGO BILOBA	6	4" MIN	12" MIN	25'	28%
	TRIDENT MAPLE	ACER BUERGERANUM	6	4" MIN	12" MIN	15'	28%
	LONDON PLANE TREE	PLATANUS X ACERIFOLIA	3	4" MIN	12" MIN	25'	14%
	GREEN ASH	FRAXINUS PENNSYLVANICA	6	4" MIN	12" MIN	15'	28%

Calculations		
EDF	Existing Density Factor	0
RDF	Replacement Density Factor	148
SDF	Site Density Factor	148
AC	Site Acres	1.48
	Tree Density Units	100
	Units to Replace	148

Parking Area 10,691 SF
 Landscape Parking Area 4,173 SF
 Landscape Parking Area % 39%

WINDY HILL ROAD
 (VARIABLE PUBLIC R/W)

LANDSCAPE PLAN

SHEET TITLE
LANDSCAPE PLAN

SHEET NUMBER
L201

PROJECT NUMBER
19325

DATE
JANUARY 23, 2020

REVISIONS

NO.	DATE	DESCRIPTION

FOR
ALTERMAN COMMERCIAL REAL ESTATE
 2970 PEACHTREE NW, STE 805
 ATLANTA, GA 30305

civilocustix
 500 SUN VALLEY DRIVE, STE H3, ROSWELL, GA 30076
 (404) 594-4403 - civilocustix.com