

Site Address-
1651 Roswell Street
Suite C

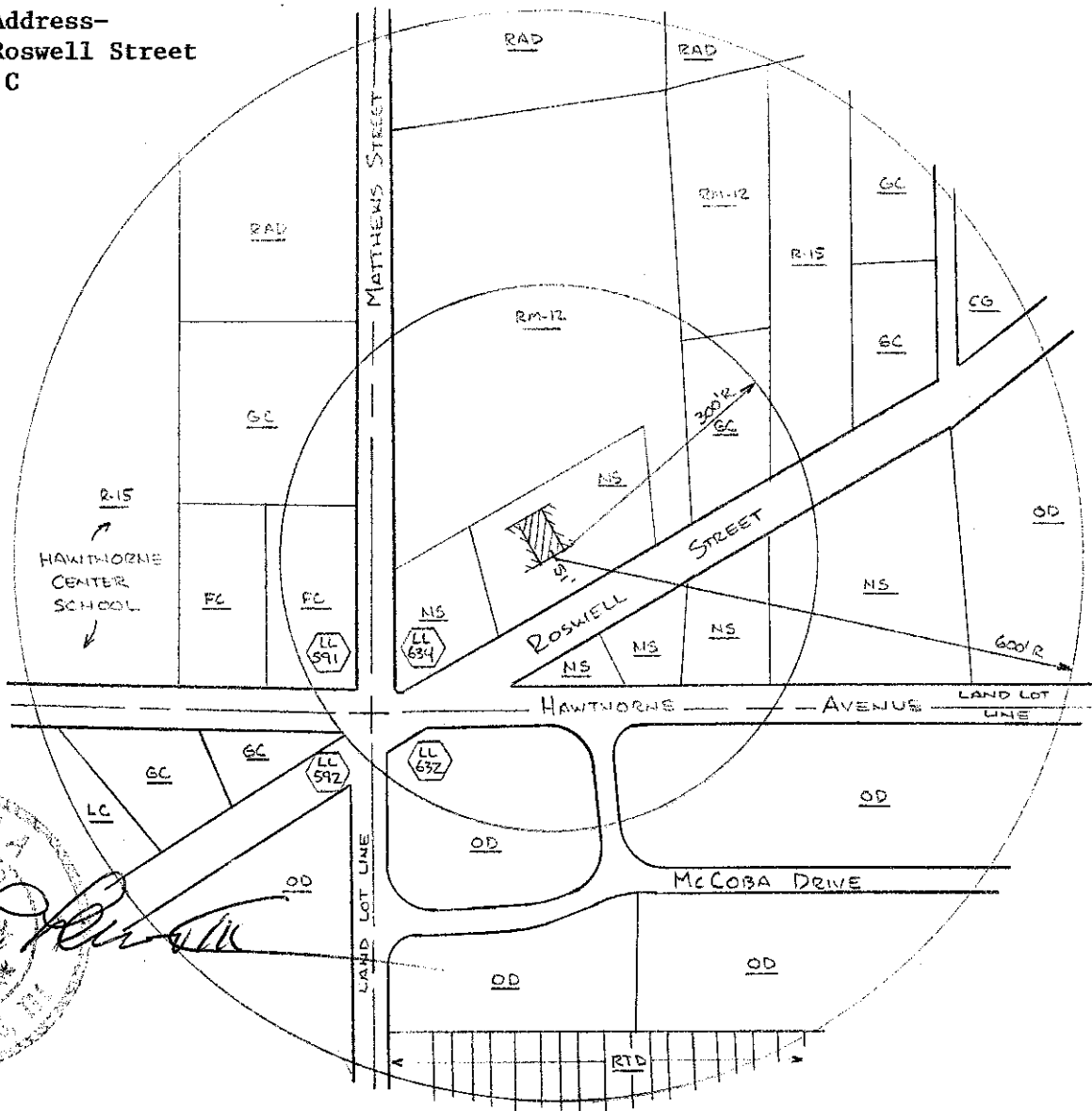

The following distances were measured according to City of Smyrna code:

CHURCH- 467' to Church of God, @ 1687 Smyrna-Roswell Road.

SCHOOL- 474' to Hawthorne Center School, @ 1595 Hawthorne Avenue.

LIBRARY- 4400' to Smyrna City Library, @ 100 Village Green Circle.

PARK- 6000' to Jonquil Park.

PUBLIC BUILDING- 4000' to Smyrna City Hall.

APARTMENT BUILDING- 302' to Morgans Point Apartments, @ unit A.

There are no alcohol treatment centers, nor day nurseries with accredited pre-K within 600' of the front door of this site.

City of Smyrna Beer and Wine Pouring License Survey for:

MOGES ABEBE

DATE: 10-22-2014	SCALE: 1" = 200'	0 100' 200' 400'
DRAWN BY: GD	GRAPHIC SCALE IN FEET	
LAND LOT 634	17TH DISTRICT	2ND SECTION
COBIB	COUNTY	GEORGIA
GEORGIA LAND SURVEYING CO. 155 CLIFTWOOD DRIVE, ATLANTA, GA 30328 PH (404)255-4671 FAX (404)255-6607 WWW.GLSURVEY.COM		194283