

SPC Georgia
West Zone

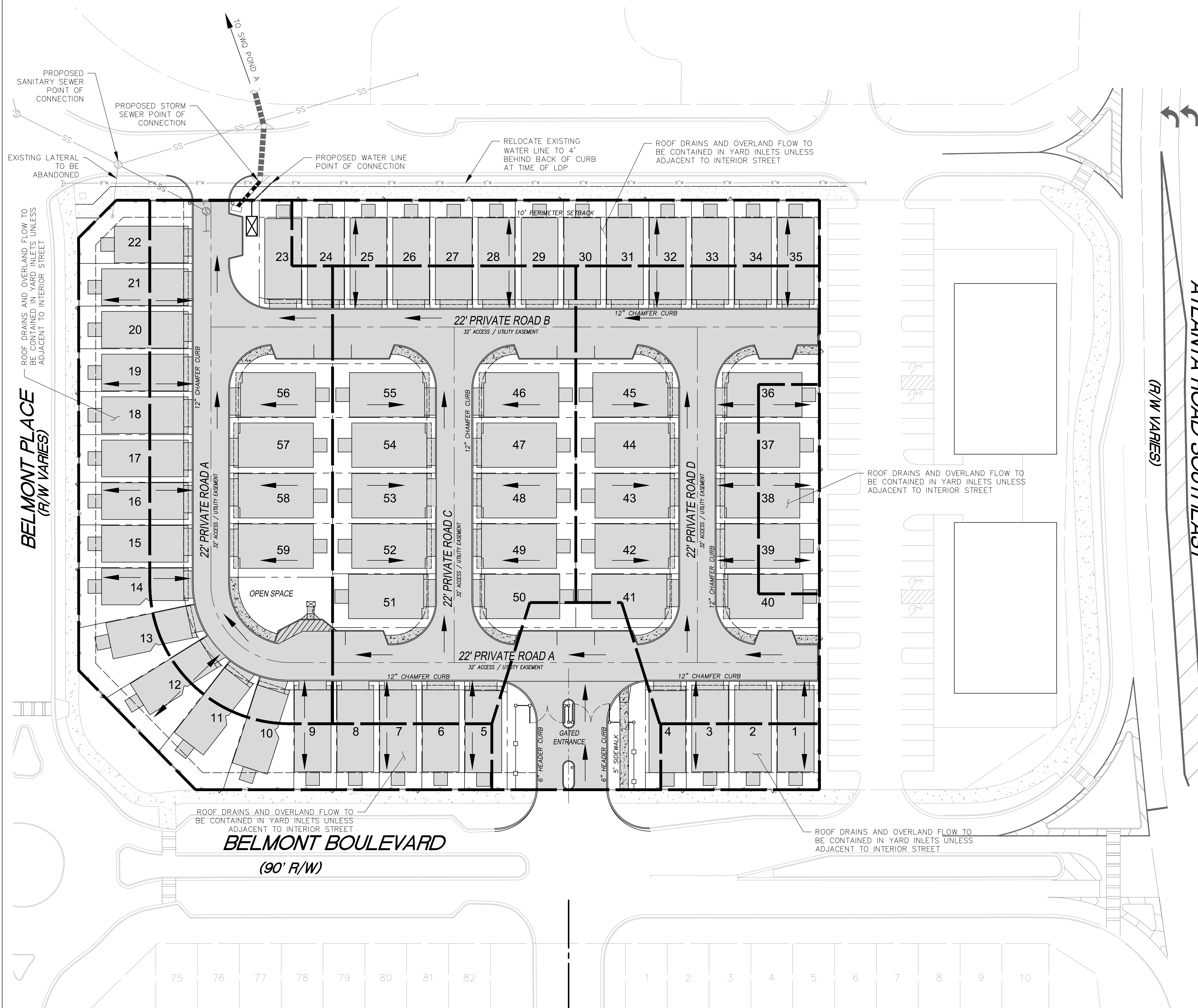

LEGEND

- PROPOSED IMPERVIOUS COVER
- EXISTING WATER LINE
- PROPOSED WATER LINE
- EXISTING SANITARY SEWER LINE
- PROPOSED SANITARY SEWER LINE
- EXISTING STORM SEWER LINE
- PROPOSED STORM SEWER LINE
- EXISTING STORM SEWER INLET
- PROPOSED DRAINAGE BASIN
- FLOW DIRECTION
- PROPOSED MASTER WATER METER

IMPERVIOUS COVER SUMMARY:

TOTAL SITE DRAINAGE.....	= 3.380 AC (147,242 SF)
PROP. IMPERVIOUS COVER.....	= 2.473 AC (107,733 SF)
PROP. IMPERVIOUS COVER PERCENTAGE.....	= 73.2% OF SITE

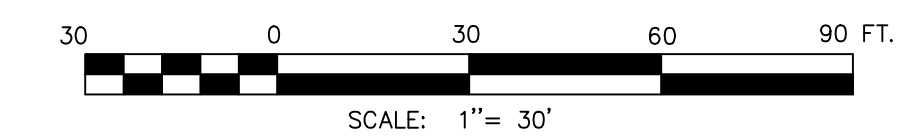

DATE :	June 30, 2017	REVISIONS
SCALE :	1" = 30 Feet	
DRAWN BY :	RD	
CHECKED BY :	RMS	

UTILITY PLAN
FOR
DAVID WEEKLEY HOMES
750 Hammond Drive, Building 6, Suite 200
Atlanta, GA 30328

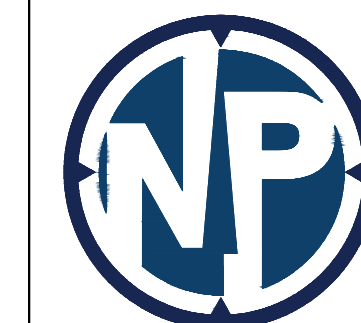

**NORTH POINT
LAND SURVEYING**
821 WYNTUCK DRIVE
KENNESAW, GEORGIA 30152
PHONE: (770) 315-5129
EMAIL: RS@NPLandSurveying.com
www.NPLandSurveying.com

LOCATED IN L.L. 490
17TH DISTRICT
CITY OF SMYRNA
COBB COUNTY, GA.
PROJECT NUMBER : 17007