

# APPLICATION FOR VARIANCE TO THE CITY OF SMYRNA

Type or Print Clearly

(To be completed by City)

Ward: 3

Application No: V15022

Hearing Date: 5/18/15

APPLICANT: GORSHA ETHIOPIAN CUISINE

Business Phone: 678 388 0441 Cell Phone: 404 932 3487 Home Phone: 404 988 7871

Representative's Name (print): \_\_\_\_\_

Address: 2595 Bates St

Business Phone: 678 388 0441 Cell Phone: 404 932 3487 Home Phone: 404 988 7871

E-Mail Address: ababewossene@gmail.com

Signature of Representative: \_\_\_\_\_

TITLEHOLDER: Samir & Samita LLC

Business Phone: \_\_\_\_\_ Cell Phone: 770 605 5318 Home Phone: 770 921 9083

Address: 1651 Roswell St Smyrna GA 30080

Signature: \_\_\_\_\_

## VARIANCE:

Present Zoning: \_\_\_\_\_

Type of Variance: Requesting reduction

in distance requirement for alcohol pouring  
from public school church

Explain Intended Use: To serve alcohol at restaurant  
at 1651 Roswell St.

Chapter 6 - Sec 6-118-b-2

Location: 1651 Roswell St

Land Lot(s): 634 District: 17 Size of Tract: \_\_\_\_\_ Acres

(To be completed by City)

Received: 4/23/15

Posted: 4/24/15

Approved/Denied: \_\_\_\_\_

**CONTIGUOUS ZONING**

North: RM-12

East: RM-12

South: NS/OD

West: NS

7009 2250 0001 6312 1236

**CERTIFIED MAIL RECEIPT**  
(Domestic Mail Only; No Insurance Coverage Provided)

For delivery information visit our website at [www.usps.com](http://www.usps.com)

**OFFICIAL USE**

Postage	\$11.49	
Certified Fee	\$3.30	
Return Receipt Fee (Endorsement Required)	\$0.00	
Restricted Delivery Fee (Endorsement Required)	\$0.00	
Total Postage & Fees	\$14.79	

Postmark Here 0047 23

Sent To: *Megans point homeowner association inc*  
Street, Apt. No., or PO Box No.: *1093 Right hawk cir, Unit 125*  
City, State, ZIP+4: *SUITE 230 Fountain Valley CA 92703*

**NOTIFICATION OF CONTIGUOUS OCCUPANTS OR LAND OWNERS TO  
ACCOMPANY APPLICATION FOR VARIANCE**

By signature, it is hereby acknowledged that I have been notified that there is school  
within 600' of the Restaurant.

Intends to make an application for a variance for the purpose of Beer and Wine  
Pouring License

on the premises described in the application.

**NAME**

**ADDRESS**

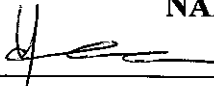
*Am.*  Vonne Ogburn  
Punya Bajracharya

1680 Roswell St. Smyrna GA 30080  
1651 Roswell St Smyrna GA 30080

**4/17/2015**

**License and Variance Board**

Dear Sirs

I have Restaurant called Gursha Ethiopian Cuisine which is the first of its kind in Cobb County. Beer and wine survey has been conducted and there is a school with in the 600 feet of the restaurant. I am applying for wavier for beer and wine pouring license after school hours for the week days as of 4.00 pm to 9.00pm and weekends 11.00 am to 9.00pm.

I look forward to hear your positive response.

Regards

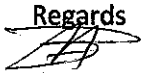
A handwritten signature in black ink, appearing to be 'Genet Tenaye', written over the word 'Regards'.

Genet Tenaye



Printed: 4/14/2015 8:36:47 PM

## Cobb County Online Tax Receipt

Thank you for your payment!

**CARLA JACKSON** TAX COMMISSIONER  
**CHELLY MCDUFFIE** CHIEF DEPUTY  
Phone: 770-528-8600  
Fax: 770-528-8679

Payer:  
**SAM & SAMITA LLC**

**SAM & SAMITA LLC**

**Payment Date: 10/15/2014**

Tax Year	Parcel ID	Due Date	Appeal Amount	Taxes Due
2014	17063400280	10/15/2014	Pay: N/A or	6906.84

Interest	Penalty	Fees	Total Due	Amount Paid	Balance
\$0.00	\$0.00	\$0.00	\$6,906.84	\$6,906.84	\$0.00

Site Address-  
1651 Roswell Street  
Suite C

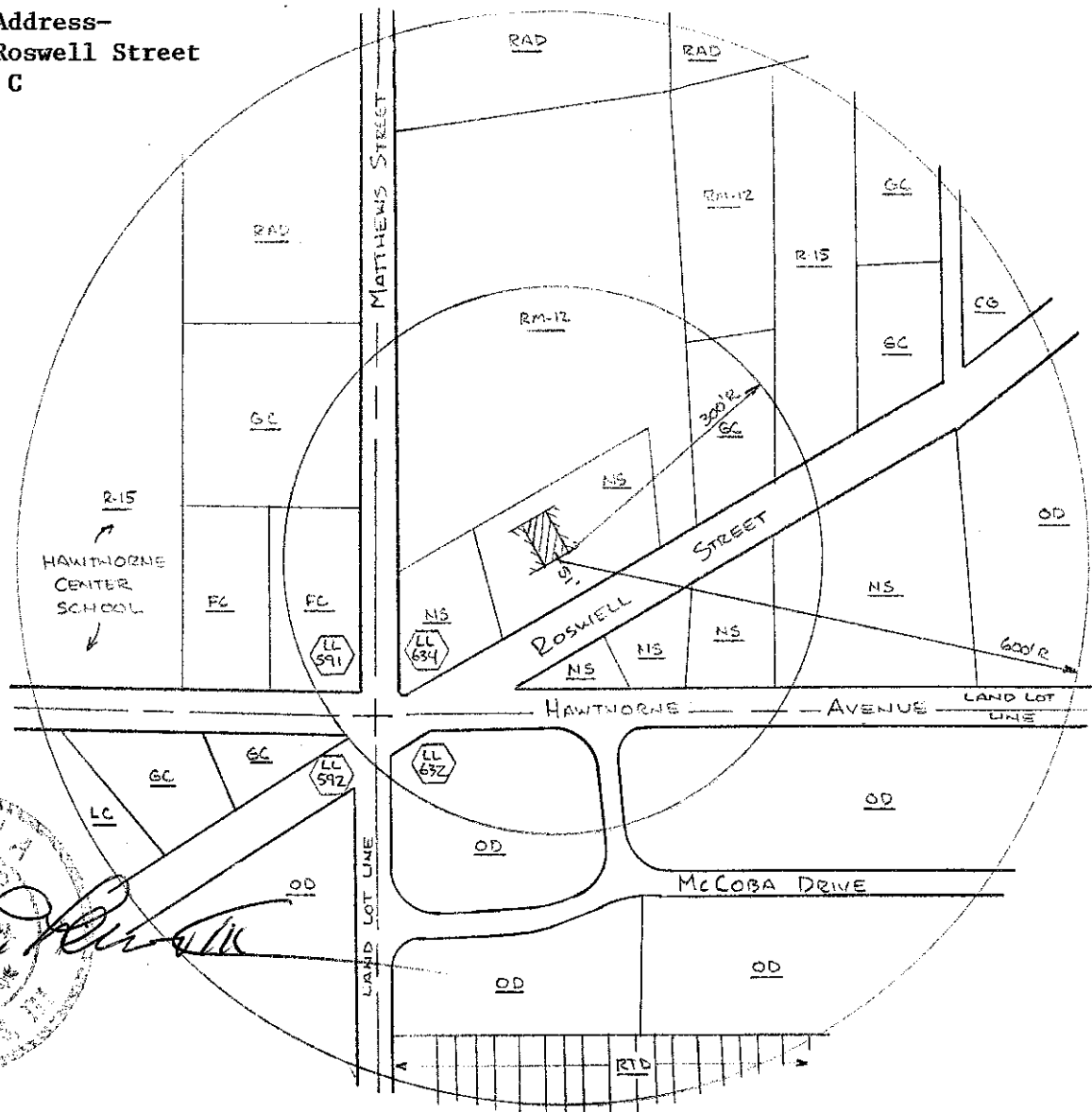

The following distances were measured according to City of Smyrna code:

CHURCH- 467' to Church of God, @ 1687 Smyrna-Roswell Road.

SCHOOL- 474' to Hawthorne Center School, @ 1595 Hawthorne Avenue.

LIBRARY- 4400' to Smyrna City Library, @ 100 Village Green Circle.

PARK- 6000' to Jonquil Park.

PUBLIC BUILDING- 4000' to Smyrna City Hall.

APARTMENT BUILDING- 302' to Morgans Point Apartments, @ unit A.

There are no alcohol treatment centers, nor day nurseries with accredited pre-K within 600' of the front door of this site.

City of Smyrna Beer and Wine Pouring License Survey for:

MOGES ABEBE

DATE: 10-22-2014	SCALE: 1" = 200'	0 100' 200' 400'
DRAWN BY: GD	GRAPHIC SCALE IN FEET	
LAND LOT 634	17TH DISTRICT	2ND SECTION
COBB COUNTY	GEORGIA	
GEORGIA LAND SURVEYING CO.		194283
155 CLIFTWOOD DRIVE, ATLANTA, GA 30328 PH (404)255-4671 FAX (404)255-6607 WWW.GLSURVEY.COM		